

# Village North

## Lebanon, IN



### 2462 N Lebanon St

- Primary retail center in the area
- Center located in front of Super Wal-Mart
- GLA: 40,087 Sq. Ft. of small shops
- Traffic Count, U.S. Hwy 39: 15,950/ADT

#### DEMOGRAPHICS

	Lebanon	Boone County
Population	14,856	54,194
Median Age	35.7	38.8
Number of Households	6,267	20,425
Average Household Size	2.33	2.61
Median Household Income	\$49,287	\$62,460
Average Household Income	\$58,550	\$85,515
Race:		
White	97.3%	97.4%
Black	0.3%	0.4%
Other	2.4%	2.2%



Regency Properties has been "Centered on Success" since 1949. Regency provides continual attention and excellent service in Asset Management, Property Management, Leasing and Development. Areas of concentration are Indiana, Illinois, Kentucky, Alabama, South Carolina, Georgia and Mississippi. Call Regency today.



**REGENCY**  
PROPERTIES  
330 Cross Pointe Boulevard  
Evansville, IN 47715-4027

**(812) 424-9200**  
regency@regency-prop.com  
www.regency-prop.com

# Village North

Boone County  
2462 N Lebanon St • Lebanon, Indiana 46052

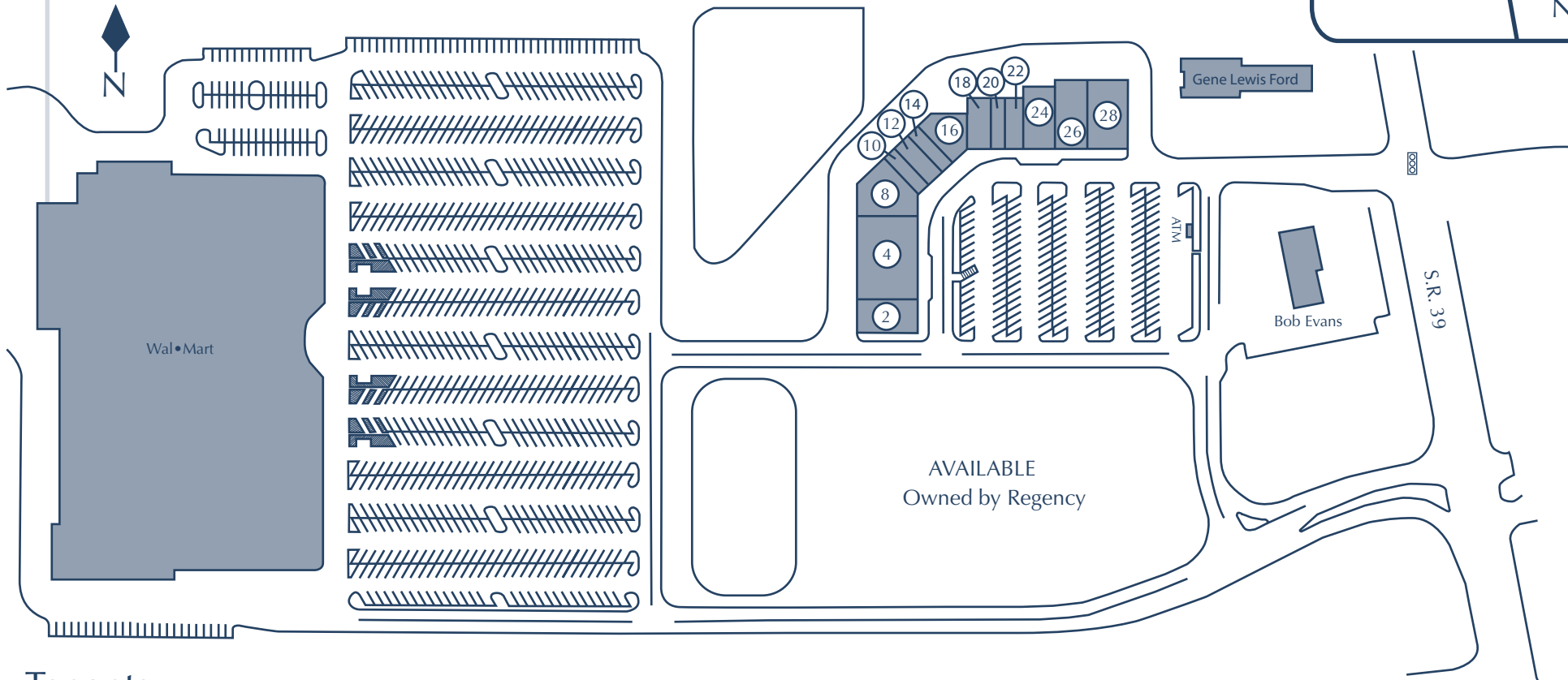
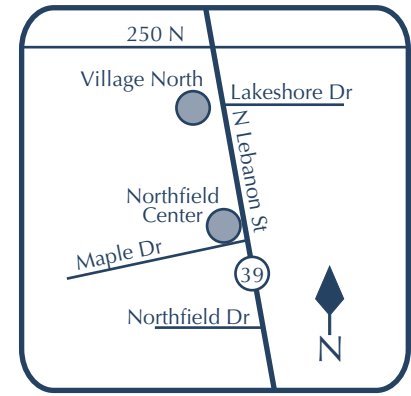

## Tenants

- |                                         |                                          |
|-----------------------------------------|------------------------------------------|
| (2) Available 2,880 Sq. Ft. (36' X 80') | (18) BonWorth (1,950 Sq. Ft.)            |
| (4) Goody's (9,120 Sq. Ft.)             | (20) Modern Nails (1,170 Sq. Ft.)        |
| (8) Buffet King (4,441 Sq. Ft.)         | (22) Subway (1,560 Sq. Ft.)              |
| (10) Great Clips (1,170 Sq. Ft.)        | (24) El Meson Restaurant (3,200 Sq. Ft.) |
| (12) Little Caesar's (1,560 Sq. Ft.)    | (26) Hallmark (3,780 Sq. Ft.)            |
| (14) Advance America (1,170 Sq. Ft.)    | (28) Speck's Pet Supply (4,768 Sq. Ft.)  |
| (16) Radio Shack (2,616 Sq. Ft.)        | (29) Key Bank - ATM                      |



330 Cross Pointe Boulevard  
Evansville, IN 47715-4027  
Voice: 812.424.9200  
Fax: 812.424.9242  
www.regency-prop.com  
regency@regency-prop.com